

Graduated Care Clinic ♦ Rapid Access Clinic

Chilliwack General Hospital

You have been referred to one of our clinics for follow-up medical care. Here you can get specialist medical care without having to stay in the hospital.



Our clinics see people who:

- have had a recent stay in the hospital
- have had a recent visit to the Emergency Department
- been seen by their family practitioner (family doctor or nurse practitioner)

Everyone we see has a need for follow-up medical care as soon as possible.

When will I have an appointment?

It depends on your medical condition, which clinic is seeing you, and how many other people we need to see.

We will call to arrange a time for you.

- **Graduated Care Clinic** - expect your first appointment to be within several days after your hospital stay or Emergency visit.
- **Rapid Access Clinic** – expect your first appointment to be within 3 weeks of us getting the request to see you.

Monday to Friday
(except Statutory Holidays)
12:00 p.m. to 5:00 p.m.

604-795-4141 Ext: 614453

45600 Menholm Road
Chilliwack, B.C

What happens in the clinic?

You see one of our specialist doctors (Internal Medicine Specialist) for an in-depth review of your health and situation.

If you need more than one appointment, you might see a different doctor each time, depending on their schedule.

As part of your appointment, we might send you for blood work, x-rays, or other tests.

Note: If we ask you to go for blood work before your appointment, please go to our hospital laboratory at least 2 hours before your clinic appointment. This is so we have your results for your appointment. Please do not use a community laboratory. We won't get your results in time.

How long will I be at the clinic?

Plan to be here for at least 3 hours. This allows you time to park, register, find the clinic, and attend your appointment. It could be longer if we want you to have other tests while you are here.

What should I bring with me?

Please bring with you:

- your questions for the doctor
- any medicines you might need to take while you are here
- a list of all the medicines you take
Include all supplements and over the counter medicines you might take (such as cannabis products, vitamins, herbal remedies)
- a snack

What if I miss or need to change my appointment?

Call us as soon as possible so we can use your time for someone else.

604 795 4141, Ext 614453

Leave your name and phone number.

Where do I go?

- Come to Chilliwack General Hospital.
- Enter through the Main Entrance.
- Follow the signs to 'Graduated Care Clinic and Diabetes Clinic'.

**If coming for Intravenous Antibiotic Therapy, stop and check in at Ambulatory Care first before coming to our clinic.
- Check in with our clerk when you arrive in our waiting area.

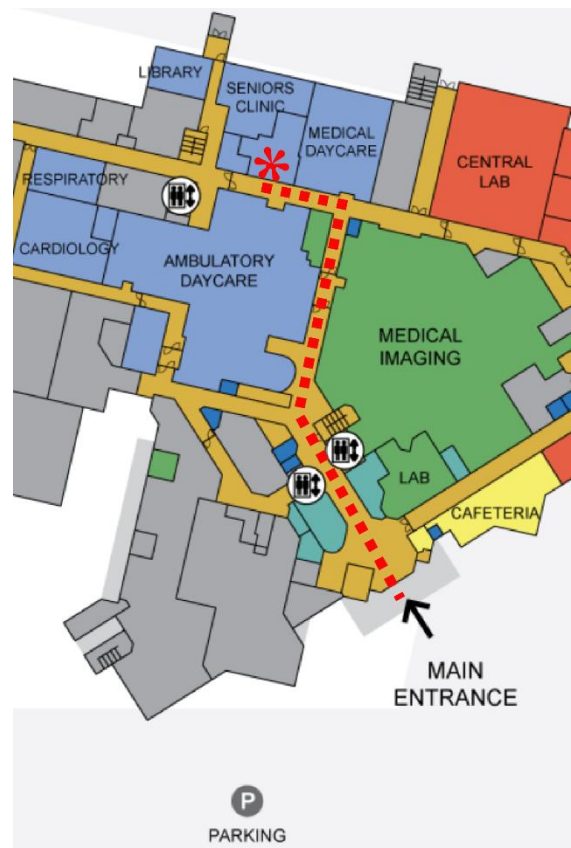

Map to Clinics in Chilliwack General Hospital